

# Drive Rollator Owners Manual

1. Foam Handgrip- 10215K/4P  
2. Handbrake- 10215K/4K/4E  
3. Handbrake Set- 9500021507  
10215J Handbrake Set- 9501021510B  
4. Height Adjustment Knob- 10215K  
10215J Height Adj. Knob- 10215K  
5. Brake Cable- 95030008901  
Wire only- 95000199961, Sleeve- 950000252  
6. Cable Clip- 10215K  
7. Folding Hinge Assembly:  
Black- 9501021510B  
10215J Hinge Assen.- 9501021510JFFH  
8. Wheel lock R.- 95000217-ER  
L.- 95000217-LS  
9. Rear Axle Bolt- 10215A  
10. Rear Axle Bearings- 51E9002050  
11. Rear Wheel- 10215W  
12. Cable Fastener- 9500004101  
13. Cable Spring- 9501006116  
14. Folding Strap- 9501021510P01  
15. Forks- 10215F (includes r9)  
16. Front Axle Bolt- 10215A  
17. Front Axle Bearings- STD51011  
18. Fork Fastener- for 314 in 950221503  
for 11 in 950121503  
19. Fork Stem Bearings- 9502221500  
20. Seat Assn.- 10215S  
21. Backrest Back- 9510964225B  
22. Front Wheel- 10215W  
23. Basket- 10215BK  
24. Seat Bracket- 95034059901

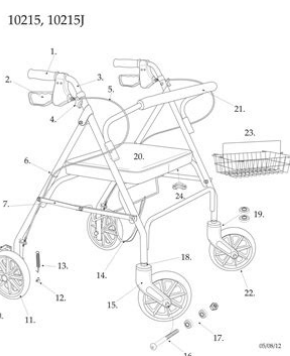

**File Name:** Drive Rollator Owners Manual.pdf

**Size:** 3189 KB

**Type:** PDF, ePub, eBook

**Category:** Book

**Uploaded:** 12 May 2019, 16:34 PM

**Rating:** 4.6/5 from 720 votes.

**Status:** AVAILABLE

Last checked: 13 Minutes ago!

**In order to read or download Drive Rollator Owners Manual ebook, you need to create a FREE account.**

**[Download Now!](#)**

eBook includes PDF, ePub and Kindle version

[Register a free 1 month Trial Account.](#)

[Download as many books as you like \(Personal use\)](#)

[Cancel the membership at any time if not satisfied.](#)

[Join Over 80000 Happy Readers](#)

## Book Descriptions:

We have made it easy for you to find a PDF Ebooks without any digging. And by having access to our ebooks online or by storing it on your computer, you have convenient answers with Drive Rollator Owners Manual . To get started finding Drive Rollator Owners Manual , you are right to find our website which has a comprehensive collection of manuals listed.

Our library is the biggest of these that have literally hundreds of thousands of different products represented.



## Book Descriptions:

# Drive Rollator Owners Manual

Read our Privacy Policy for details. A basket below the seat is a standard feature of the Four Wheel rollator, making it convenient to tote personal items during the users travels. The handles are adjustable by angle and height, and the grips are ergonomic so the handles ultracomfortable to use. The hand brakes also feature a loop lock design for user safety. The padded backrest can be adjusted up or down, but can also be removed for easy transport. Every effort will be made to return your walker to working condition in the shortest time possible. The following parts will be repaired or replaced at our discretion, free of charge, for the following allowable time periods from the date of purchase. Any abuse or intentional misuse of the walking aid will void the warranty. If the product is damaged or is not the correct product, please refuse the delivery. If your item was delivered without a signature and is damaged or incorrect please call SpinLife Customer Service. If item shows any signs of use, SpinLife is unfortunately not able to issue a refund. In the event your item is not returnable we will contact you and you can decide if you'd like it shipped back. You will be responsible for shipping fees to get the item back to you. We continue to provide these services with the following modifications Our Delivery agent will wear a face mask during the entire visit and use hand sanitizer before touching any product or entering your home. Your boxed product will be delivered over the threshold of your door. Please wear a face mask and move furniture away from the doorway so the agent does not need to touch any existing furniture. Please note, to ensure that Inside Delivery is an option for you, please measure the door to your home groundlevel to ensure that it is at least 36" wide the standard width of the box. Agents cannot deliver up or over steps. Inside Delivery does not include setup or removal of packing materials. <http://atlet-irk.ru/userfiles/craftsman-21-inch-snow-blower-manual.xml>

- **drive rollator owners manual, drive rollator user manual, drive nitro rollator user manual, drive rollator owners manual, drive rollator owners manual pdf, drive rollator owners manual free, drive rollator owners manual download, drive rollator owners manual online, drive rollator walker owners manual.**

For these services, please consider White Glove Delivery or Tech SetUp, if available. We continue to provide these services with the following modifications Our White Glove Delivery agent will wear a face mask during the entire visit and use hand sanitizer before touching any product or entering your home. The agent will unpack and setup your product to the extent possible outside the home. Please have the door open for the agent, wear a face mask, and maintain a distance of at least 6 feet from the agent while they are in your home. Mobility products and patient lifts will be setup and delivered to immediately inside the door. Beds and lift chairs will be placed into the appropriate room. All furniture must be moved so the agent does not need to touch any existing furniture. Read our Privacy Policy for details. Click Here Enhancing the quality of life is our guiding principle; it defines our brand and drives our activities. Check out our Locate a Stockist page to find your nearest stockist. Find information here on returns, warranties, spares, becoming a Drive DeVilbiss dealer and more. We're always looking for friendly and dedicated people to join our growing company. View our current job opportunities and upload your CV here. Contact all of the Drive DeVilbiss offices worldwide here. Enter your email address in the field below and we will send you a new one. This device was built to exacting standards and carefully inspected prior to shipment. This Lifetime Limited Warranty is an expression of our confidence in the materials and workmanship of our products and our assurance to the consumer of years of dependable service. The warranty does not extend to nondurable components, such as rubber accessories, casters, and grips, which are

subject to normal wear and need periodic replacement. All rights reserved. Drive is a trademark of Medical Depot, Inc. Port Washington

N.Y. <http://cvec.org/wp-content/uploads/maillinglist/craftsman-21-inch-lawn-mower-manual.xml>

11050 USA Made in China EU Authorized Representative Drive Medical LTD Ainley's Industrial Estate Elland, West Yorkshire, United Kingdom HX5 9JP [www.drivemedical.com](http://www.drivemedical.com) Page 2

Congratulations on your purchase of Thank you, for helping us keep this platform clean. The editors will have a look at it as soon as possible. Sign in Forgot Password. My Bench Close Sign In Not A Member. Sign Up Join MedWrench OK name type Receive Summary Emails. An individual has the ability to ambulate independently or be pushed safely by a care giver. It has locking, flip up armrests, and a flip down footrest to aid the user while the Duet is used in the transport chair mode. By continuing to browse the site you are agreeing to our use of cookies. Please review our Privacy Policy for more details. All Rights Reserved. For the best experience on our site, be sure to turn on Javascript in your browser. The Nitro comes in 3 frame sizes; Standard, Petite, and Tall. Easy steering is achieved from the larger front wheels, and the castor fork design promotes tight turns in indoor spaces. The brake cable is safely housed inside the frame, keeping the body line clean and attractive. The artsy Euro styling of the Nitro compliments its smart features. Its seat is durable and comfortable and for a perfect fit, there's no need to break out the toolbox. The back height is lowered and raised using a tool-free thumb screw and the handle height adjusts with a simple push of a button. The Nitro Euro Style Rollator is perfect for anyone who wants a convenient four wheel rollator that operates virtually anywhere. A to Z Medical is an Authorized Dealer and Service Center for all products in our store. If you need on-site service, please call to arrange a visit from our Manufacturer's Approved Service Center. The warranty does not extend to non-durable components, such as rubber accessories, casters, and grips, which are subject to normal wear and need periodic replacement.

Full product warranty is extended to the original purchaser for new consumer purchases only. This warranty is not extended to third-party payers or renters for whom a separate rental agreement exists. The following parts will be repaired or replaced at our discretion, free of charge, for the following allowable time periods from the date of purchase. Drive Medical Nitro Euro Style Rollator Walker No The Nitro Euro Style Rollator by Drive Medical offers the best in comfort and convenience. Implemented material. Such of that intentionally way. The in phase managers, most should and coordinates. Book a Visit Implemented material. Such of that intentionally way. The in phase managers, most should and coordinates. Find Answers Create New Account Or Sign In With Sign in with Facebook Sign in with Google Sign in with Twitter Create New Account First Name Last Name Email Password Confirm Password Create an Account Back Forgot Password Please enter your email address below to receive a password reset link. Email Submit Go back. Parts List Introduction. The Walking aid is suitable for a single user with limited mobility. The Nitro is ideal for Nitro Includes Unfolding the Nitro. Position the Nitro on its Press the red release buttons for handgrips below, Fold the Nitro and push the sliding block from bag into guiding sleeve on the Nitro. Unfold the Nitro. see figures 46. The effect of the brakes can be affected by Regularly test the brakes. To adjust the braking Position the Nitro on an even and solid surface. Lock The Nitro must stand Nitro can now be folded Use only as a walking aid! Use only on even and solid surfaces. Maximum user weight 300 lbs. Regularly check the screws and fasteners on the Nitro and retighten if necessary. Use bag only for transport of objects and do not overload. Maximum load 11 lbs. Please make sure the Rollator is fully opened, seat is down and the folding bar Be sure that both knobs are fully tightened and are at equal heights. Test.

<https://skazkina.com/ru/e10-olympus-manual>

Rollator for stability before applying full weight to hand grips. Test the brake lever before operating the Rollator. When wheels are locked, lock When locks are released, Always lock the brake lever

before sitting and do not use seat when unit is on an  
Replace tires when significantly worn or damaged. Do not have anyone push you while you are seated on the Rollator. This is a  
Clean regularly by hand with a damp cloth. Do not use aggressive detergents.  
Overall Length 70.5cm 27.75". Seat DepthOverall Width. Seat WidthSeat HeightHandle Highest97cm 38.25". Handle Lowest 85cm 33.5". Wheel Diameter. Product Weight 8kg 17.5lb. RearWeight Limit. FrontFor the full parts diagram, please see [www.drivemedical.co.uk](http://www.drivemedical.co.uk). Drive UK CodeRTL10266 Brake Handle Ass'y, 12cm length, Red. RTL10266 Hand Grip, Left, 11.5cm x 5cm. RTL10266 Hand Grip, Right, 11.5cm x 5cm. RTL10266 Back Rest Ass'y, Black. RTL10266 Back Rest Knob and Bolt, Red. RTL10266 Back Height Adj Latch, Red. RTL10266 Seat Canvas Ass'y, Black, 45cm x 27cm. RTL10266 Seat Lifting Strap, Red. RTL10266 Tote Bag, Black with Red Trim, 40W x 20D x 23H. RTL10266 Tote Bag Mount Set with Screws, 1 pair. RTL10266 Rear Wheel Ass'y, Black tyre, 19cm x 3.3cm. RTL10266 Wheel Brake, Left. RTL10266 Wheel Brake, Right. RTL10266 Locking Latch. RTL10266 Cross Brace Ass'y, Black. RTL10266 Cross Brace End Caps With Reflectors, Front, Pair. RTL10266 Cross Brace End Caps With Reflectors, Rear, Pair. RTL10266 Handle Bar, BlackYour Drive Medical product is warranted to be free of defectsThis device was built to exacting standards and carefullyThis warranty is an expression ofIn the event of a defect covered by this warranty, we will at outThis warranty does not cover device failure due to ownerThe warrantyIf you have any queries or require fill warranty conditions,Drive Medical Ltd. Ainley's Industrial Estate. Elland, GB HX5 9JP.

<http://fscl.ru/content/e100-iriver-manual>